

# MuralBloc

80 L / 110 L



Aerothermics for domestic hot water



# MuralBloc

**80 L / 110 L**

The MuralBloc water heat pump is part of our range of efficient domestic water heating systems.

It is highly efficient with low running costs. Up to 3-4 times less than conventional electric or gas heaters.



Renewable energy



Energy efficiency class



Photovoltaic and solar thermal connection.



Reduced electricity consumption.

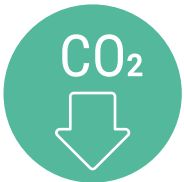

Low CO<sub>2</sub> emissions.



LCD display.



WiFi

- Units can be installed near the kitchen, in the boiler-room or the garage, basically in every room which has waste-heat so that the unit has the higher energy efficiency even with very low outside winter temperatures.
- Hot water and dehumidification. It can be placed in the laundry room or clothing room. When it produces hot water it lowers the temperature and dehumidifies the room as well.
- Storage room cooling. Units can be placed in the storage room as the low temperature keeps the food fresh.
- If placed in the garage, gym, basement etc. it produces hot water, it cools the room and supplies fresh air.
- Compatible with different energy sources. Units can be compatible with solar panels, external heat pumps, boilers or other different energy sources.
- Ecological and Economical Heating. It is the most efficient and economical alternative to both fossil fuel boilers and heating systems. By making use of the renewable source in the air, it consumes much less energy.

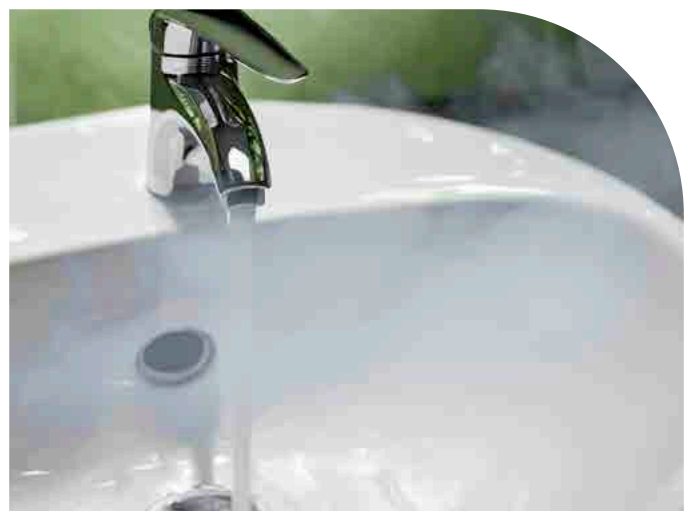

# Data sheet

Data	Unit.	80 L	110 L
Capacity	kW	0.85* (+1.5**)	
Energy Class (ERP)		A+***	
COP (ERP)		2.62***	
Duct air flow (nom.)	m³/h	300	
Rated power input	W	236 (+1500**)	
Current (nom.)	A	1.16* (+6.5**)	
Current (Rated.)	A	1.81(+6.5**)	
Power supply	V/Ph/Hz	220-240~/1/50	
Max outlet water temp. (without using E-heater)	°C	60	
Refrigerant	.../g	R134a/650	
Rated water yield	L/H	19	
Max. Water operating pressure	Mpa	1.0	
Rated water pressure	Mpa	0.6	
Set point relief valve	Mpa	0.7	
Sound pressure level	dB (A)	48.5	
Net weight	kg	50	58
Net size (WxHx)	mm	φ520x1160	φ520x1368
Package Size (WxHxD)	mm	580x580x1285	580x580x1515

\* Capacity and power input based on the following conditions:  
Ambient temperature 20°C /15°C, water temperature from 15°C to 55°C.  
\*\* Related to the supplementary heater  
\*\*\* Water heating energy efficiency based on standard ERP, M cycle:  
Ambient temperature 7°C /6°C, water temperature from 10°C to 55°C.



Energy efficiency class

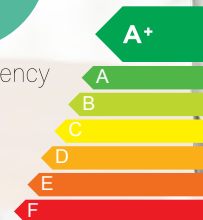

## Main features:

- Compact design
- Especially designed for offering sanitary hot water for family use.
- Extremely compact structure and elegant design; suitable for indoor installation.
- Multiple Functions: The unit can work as just a heat pump but also as a fresh air blower, a dehumidifier, or an energy recovery device.
- Stainless steel tank and a magnesium stick assure the durability of components and the tank.
- High efficiency compressor with R134a refrigerant.
- Electrical element available in the unit as a back-up, assuring constant hot water even in extreme cold winters.



LCD main panel grant access to all equipment features in an easy, convenient way.

# Equipment installation



## Required service space

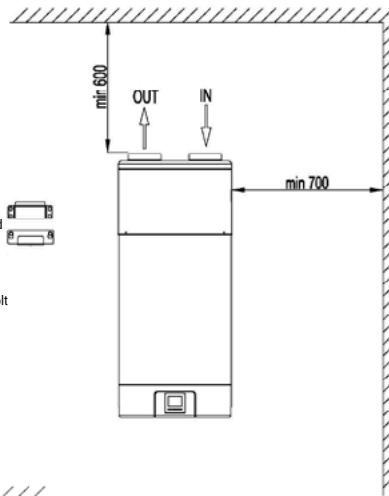
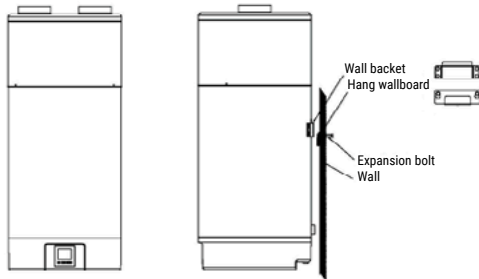

**Nota:**

- If air inlet and/or outlet pipes are connected, portion airflow and capacity in heat pump unit will lose.
- If the unit connects with air ducts it should be DN 125mm for pipes or 125mm internal diameter flexible hose.
- Total length of the ducts should not be longer than 8m or the maximum static pressure should not exceed than 60Pa.
- Be in mind of bending site of the duct no more than 4m.

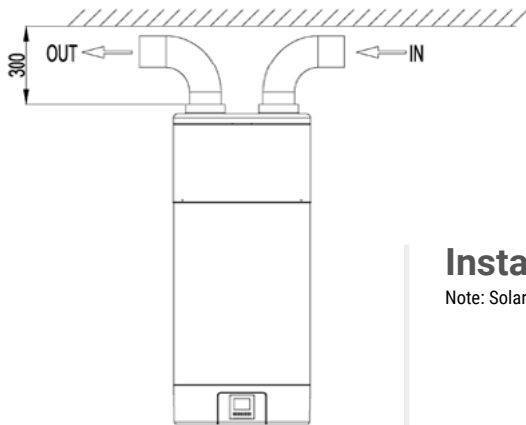

Max inclination for manual transport during installation.

## Installation overview

Note: Solar heat exchange coil is optional.

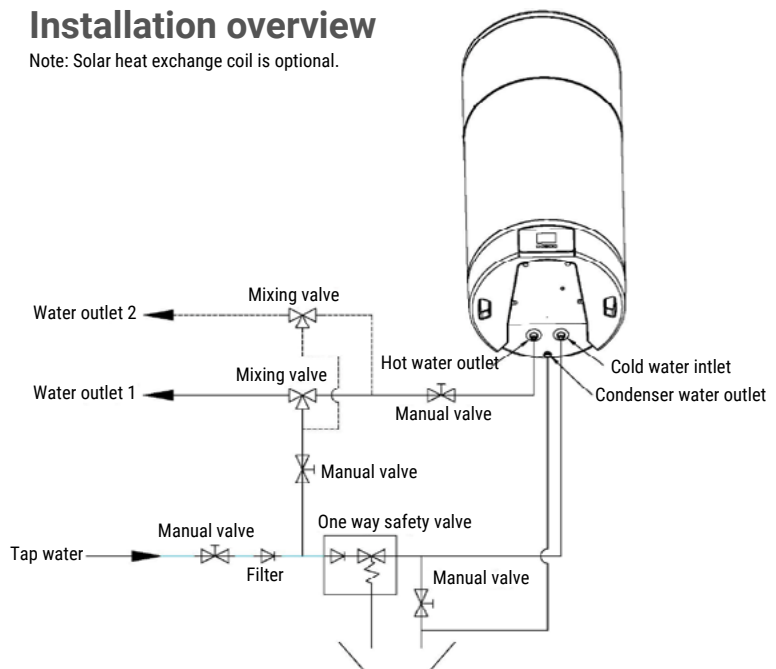

# Equipment dimensions

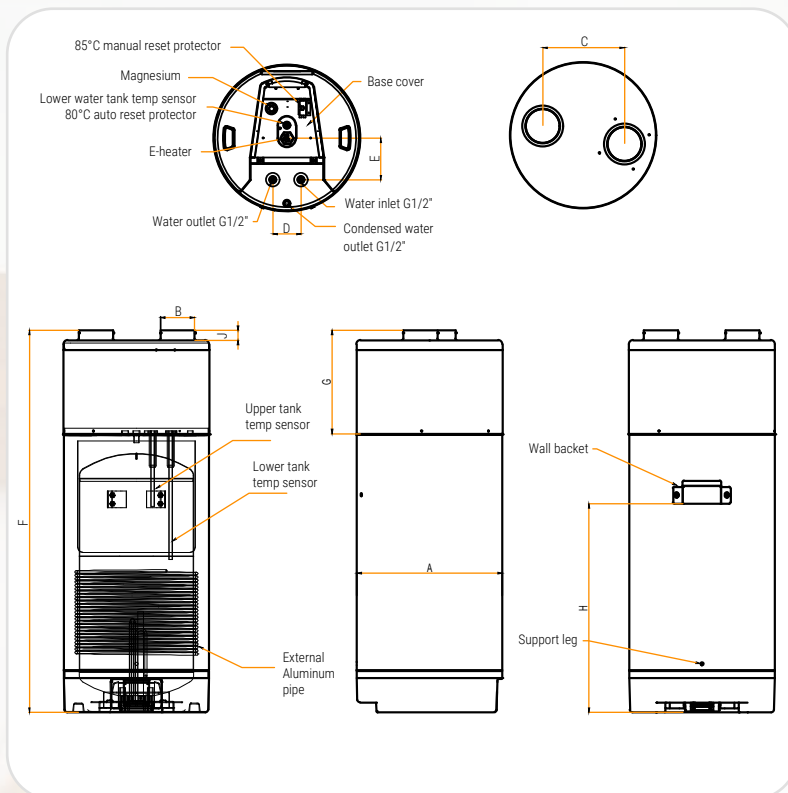

Dimensions	MuralBloc 80 L	MuralBloc 110 L
A	Ø 520	Ø 520
B	Ø 120	Ø 120
C	290	290
D	100	100
E	150	150
F	1160	1367.5
G	370	370
H	540	750
J	35	35

**Remark:**

- 1) The extra heat source is optional.
- 2) The Magnesium stick is an anti-corrosion element. It is assembled in the water tank to avoid the creation of fur around the inside tank and to protect the tank, and other components. It can help to extend the life-span of the tank. Check the magnesium stick every half year and change it if it has been used out !

- This catalog is for informational purposes only and does not constitute a contractual offer.
- The contents of this catalog are written in accordance with industry standards and criteria to the best of our knowledge.
- No express or implied warranty is provided regarding the completeness, accuracy, reliability, or suitability for a particular purpose of the products and services presented.
- Specifications and prices are subject to change without prior notice. THERMOIBÉRICA explicitly disclaims any direct or indirect liability, in the broadest sense, arising from or related to the use or interpretation of this catalog.
- Prices are subject to VAT at the applicable rate.

