

MuralBloc

80 L / 110 L



Aerothermics for domestic hot water



Scan and view in the web
MuralBloc



Rev. 28012024-1

MuralBloc

80 L / 110 L

The MuralBloc water heat pump is part of our range of efficient domestic water heating systems.

It is highly efficient with low running costs. Up to 3-4 times less than conventional electric or gas heaters.



Renewable energy



Energy efficiency class

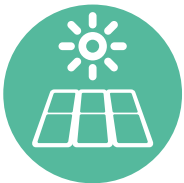

Photovoltaic and solar thermal connection.



Reduced electricity consumption.

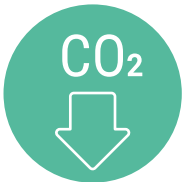

Low CO2 emissions.



LCD display.



WiFi

- Units can be installed near the kitchen, in the boiler-room or the garage, basically in every room which has waste-heat so that the unit has the higher energy efficiency even with very low outside winter temperatures.
- Hot water and dehumidification. It can be placed in the laundry room or clothing room. When it produces hot water it lowers the temperature and dehumidifies the room as well.
- Storage room cooling. Units can be placed in the storage room as the low temperature keeps the food fresh.
- If placed in the garage, gym, basement etc. it produces hot water, it cools the room and supplies fresh air.
- Compatible with different energy sources. Units can be compatible with solar panels, external heat pumps, boilers or other different energy sources.
- Ecological and Economical Heating. It is the most efficient and economical alternative to both fossil fuel boilers and heating systems. By making use of the renewable source in the air, it consumes much less energy.



Data sheet

| Data | Unit. | 80 L | 110 L |
|---|-------------------|----------------|--------------|
| Capacity | kW | 0.85* (+1.5**) | |
| Energy Class (ERP) | | A+*** | |
| COP (ERP) | | 2.62*** | |
| Duct air flow (nom.) | m ³ /h | 300 | |
| Rated power input | W | 236 (+1500**) | |
| Current (nom.) | A | 1.16* (+6.5**) | |
| Current (Rated.) | A | 1.81(+6.5**) | |
| Power supply | V/Ph/Hz | 220-240~/1/50 | |
| Max outlet water temp. (without using E-heater) | °C | 60 | |
| Refrigerant | .../g | R134a/650 | |
| Rated water yield | L/H | 19 | |
| Max. Water operating pressure | Mpa | 1.0 | |
| Rated water pressure | Mpa | 0.6 | |
| Set point relief valve | Mpa | 0.7 | |
| Sound pressure level | dB (A) | 48.5 | |
| Net weight | kg | 50 | 58 |
| Net size (WxHx) | mm | φ520x1160 | φ520x1368 |
| Package Size (WxHxD) | mm | 580x580x1285 | 580x580x1515 |

* Capacity and power input based on the following conditions:
Ambient temperature 20°C /15°C, water temperature from 15°C to 55°C.
** Related to the supplementary heater
*** Water heating energy efficiency based on standard ERP, M cycle:
Ambient temperature 7°C /6°C, water temperature from 10°C to 55°C.

Main features:

- Compact design
- Especially designed for offering sanitary hot water for family use.
- Extremely compact structure and elegant design; suitable for indoor installation.
- Multiple Functions: The unit can work as just a heat pump but also as a fresh air blower, a dehumidifier, or an energy recovery device.
- Stainless steel tank and a magnesium stick assure the durability of components and the tank.
- High efficiency compressor with R134a refrigerant.
- Electrical element available in the unit as a back-up, assuring constant hot water even in extreme cold winters.



Energy efficiency class

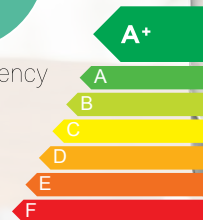

LCD main panel grant access to all equipment features in an easy, convenient way.

Equipment installation



Required service space

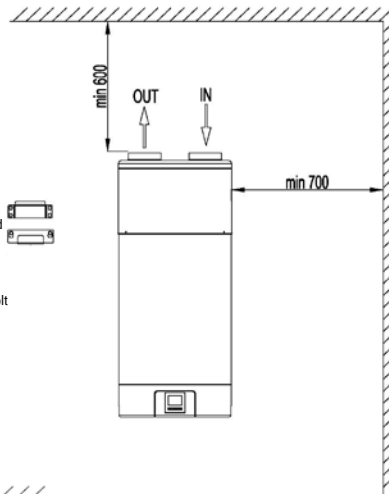
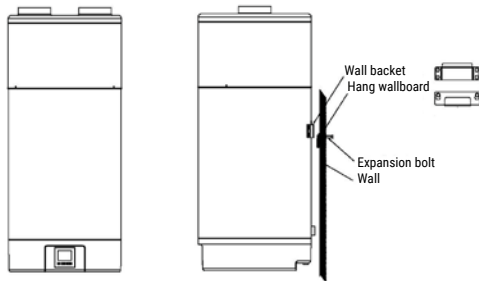

Nota:

- If air inlet and/or outlet pipes are connected, portion airflow and capacity in heat pump unit will lose.
- If the unit connects with air ducts it should be DN 125mm for pipes or 125mm internal diameter flexible hose.
- Total length of the ducts should not be longer than 8m or the maximum static pressure should not exceed than 60Pa.
- Be in mind of bending site of the duct no more than 4m.

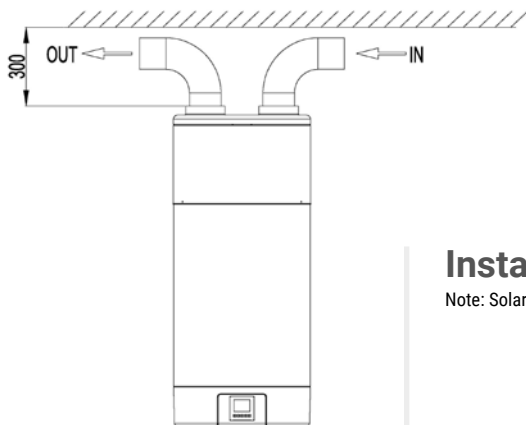

Max inclination for manual transport during installation.

Installation overview

Note: Solar heat exchange coil is optional.

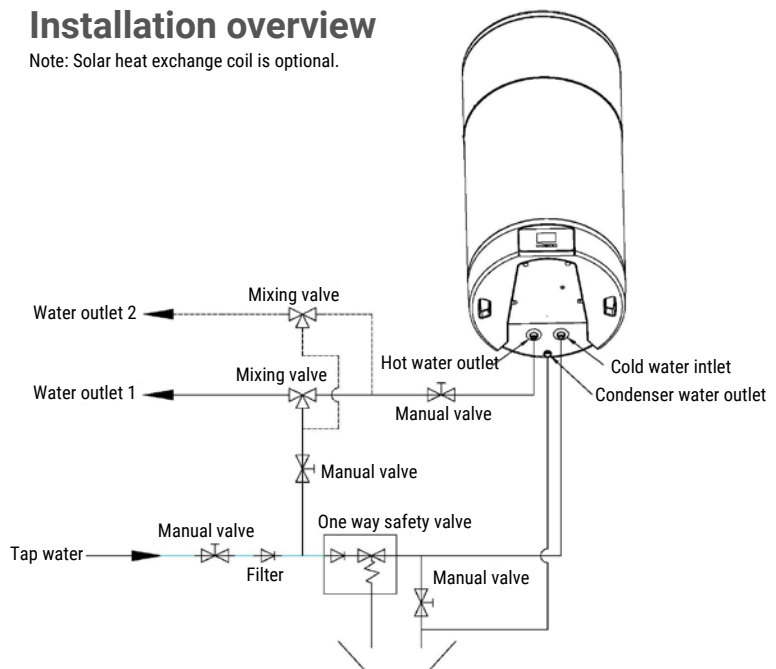

Equipment dimensions

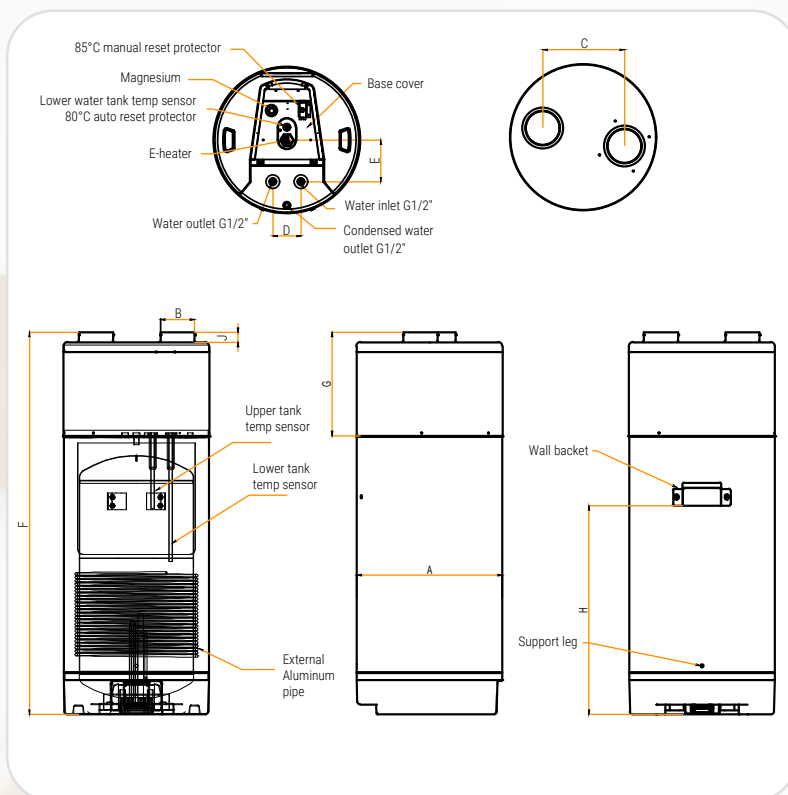

| Dimensions | MuralBloc 80 L | MuralBloc 110 L |
|------------|----------------|-----------------|
| A | Ø 520 | Ø 520 |
| B | Ø 120 | Ø 120 |
| C | 290 | 290 |
| D | 100 | 100 |
| E | 150 | 150 |
| F | 1160 | 1367.5 |
| G | 370 | 370 |
| H | 540 | 750 |
| J | 35 | 35 |

Remark:

- 1) The extra heat source is optional.
- 2) The Magnesium stick is an anti-corrosion element. It is assembled in the water tank to avoid the creation of fur around the inside tank and to protect the tank, and other components. It can help to extend the life-span of the tank. Check the magnesium stick every half year and change it if it has been used out !

- This catalog has been created for information purposes only and does not constitute a contractual offer.
- TEJADO ELÉCTRICO S.L. is the owner of the trademark THERMOIBÉRICA. The contents of this catalog are written in accordance with industry standards and criteria to the best of its knowledge.
- No express or implied warranty is given as to the completeness, accuracy, reliability or fitness for a particular purpose of the products and services it presents.
- Specifications and prices are subject to change without notice. TEJADO ELÉCTRICO S.L. (THERMOIBÉRICA) explicitly disclaims any direct or indirect damages in the broadest sense, resulting from or related to the use and/or interpretation of this catalog.
- Applicable prices plus VAT in current force.

